



# City Terminal

The City Terminal is used where life pulsates and people spend time on a daily basis: petrol stations, train stations, supermarkets, company car parks, large residential areas and so on.

## A characteristic feature is quick and easy access at all times

This solution is suited to supermarkets, wholesalers, retailers etc. with their own online shops, or with a rental or repair service. The City Terminal can however also be used for larger residential areas. The system can be used both indoors and outdoors.

However, it may be the case that a company does not offer a home delivery service, or the home infrastructure is simply lacking in terms of somewhere to store a package. Here, there is virtually no means of reaching customers who are unable to shop during conventional opening times. With a City Terminal, store opening hours can be extended to 24 hours, 7 days a week. The customer orders an item, which is subsequently placed in a City Terminal. Customers are also advised of availability via SMS or email notification, and can pick up their item when it best suits them.

## Modular City Terminal design

- Each City Terminal contains at least one control unit.
- The control unit has virtually unlimited expansion possibilities, with seven module variants. This means that the Terminal can be fully tailored to customer requirements.
- City Terminals offer five different standard compartments (from XS to XL), as well as two special compartments for clothing.

## Product features

- Opening hours extended to 24/7
- New sales opportunities
- Increased reach
- Customers can pick up ordered items on their way home.
- Employee utilisation can be increased, as a result of Terminal use.
- Terminals allow easy delivery and return of packages and shipments, ordered via e-commerce trading in the B2C / C2B market.
- The sophisticated software contains tools for analysing purchasing behaviour.
- The Terminals are equipped with the latest technology, and can be positioned both indoors and outdoors.

## City Terminal

### 1\_City Terminal control unit

Includes	industrial PC 15" touchscreen integrated, BLE mainboard, 4G router, NFC, scanner
Compartments	1 x L and 1 x XL or 1 x L and 3 x M
Power	Input voltage: 230 Volt 1-phases ~, 50 Hz, consumption 0,085KW/h Max. 0,130KW/h (85W/h - 130W/h)
Dimensions*	Height 2000 x Width 515 x Depth 640 mm
Weight	approx. 121 kg

### 2\_City Terminal roof (for outdoor use)

Protection and light	A roof is available for outdoor use. A roof with integrated LED lighting can optionally be ordered for each module.
----------------------	---

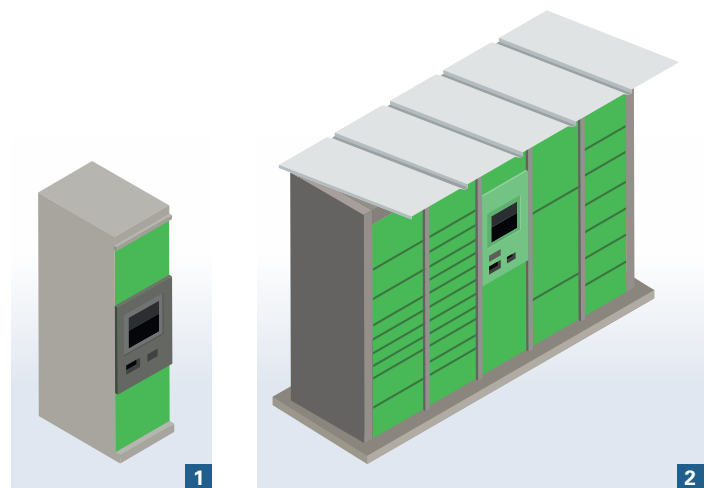

\* Tolerance differences of 2 % possible

# City Terminal

## City Terminal Modules

### 3\_ with 3 compartments

Compartments	1 × L and 2 × XL
Dimensions*	Height 2000 × Width 515 × Depth 640 mm
Weight	Approx. 95 kg

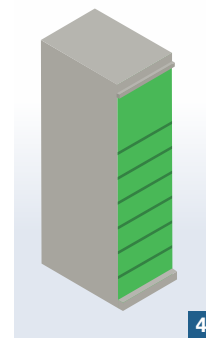
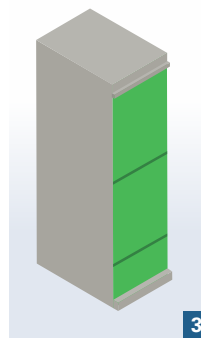

### 4\_ with 7 compartments

Compartments	6 × M and 1 × L
Dimensions*	Height 2000 × Width 515 × Depth 640 mm
Weight	approx. 106 kg

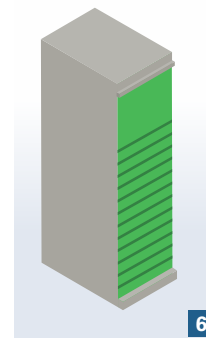
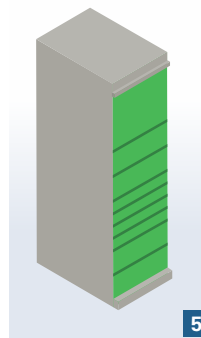

### 5\_ with 9 compartments

Compartments	4 × S, 4 × M and 1 × L
Dimensions*	Height 2000 × Width 515 × Depth 640 mm
Weight	approx. 112 kg

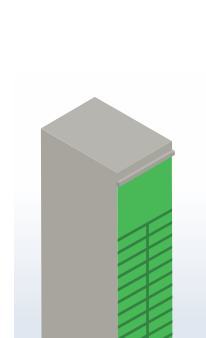
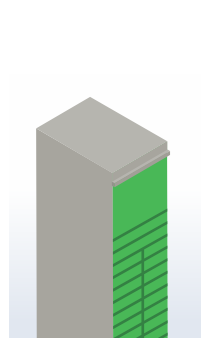

### 6\_ with 13 compartments

Compartments	12 × S and 1 × L
Dimensions*	Height 2000 × Width 515 × Depth 640 mm
Weight	approx. 129 kg

### 7\_ with 20 compartments

Compartments	16 × XS, 2 × S, 1 × M and 1 × L
Dimensions*	Height 2000 × Width 533 × Depth 640 mm
Weight	approx. 150 kg

### 8\_ with 22 compartments

Compartments	20 × XS, 1 × M and 1 × L
Dimensions*	Height 2000 × Width 533 × Depth 640 mm
Weight	approx. 152 kg

### 9\_ with 3 compartments for laundry

Compartments	1 × F.1 and 2 × F.2
Dimensions*	Height 2000 × Width 533 × Depth 640 mm
Weight	approx. 133 kg

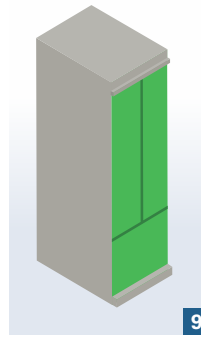

\* Tolerance differences of 2 % possible

## Dimensions (mm)

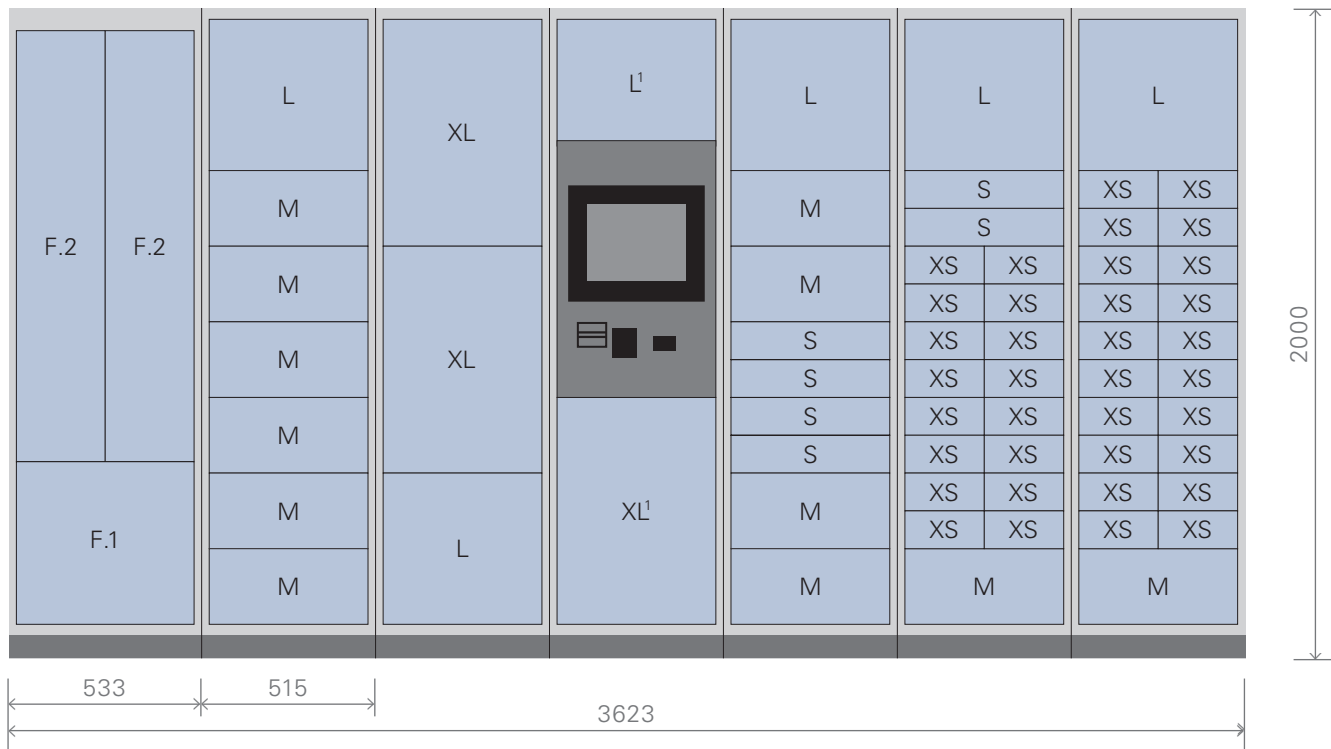

## Compartment size breakdown (internal dimensions\*)

Module	XS	S	M	L/L <sup>1</sup>	XL/XL <sup>1</sup>	F.1	F.2
Height (mm)	95	95	210	440/349 <sup>1</sup>	720/708 <sup>1</sup>	560	1300
Width (mm)	200	425	425	425	425	498	240
Depth (mm)	610	610	610	610	610	610	610

## Compartment composition

Module	XS	S	M	L	XL	F.1	F.2
Control unit			3x	1x / 1x	1x		
3x module				1x	2x		
7x module			6x	1x			
9x module		4x	4x	1x			
13x module		12x		1x			
20x module	16x	2x	1x	1x			
22x module	20x		1x	1x			
Clothing module						1x	2x

\* Tolerance differences of 2 % possible

# City Terminal

## Facts

### Colours

24/7 Smart Terminals are now even more durable, thanks to a special powder coating. Terminals are optionally available in over 200 RAL colours.

### Prerequisites: Technology/location

- Level and accessible surface (ideally a foundation).
- Power supply
- Internet access via cable, Wi-Fi or radio (SIM card) 3G, 4G.

### Outdoor location

A roof is also available for outdoor use. The roof prevents damage from rain, hail, etc.

### Safety opening for large compartments

Large compartments can be opened from the inside in the event of emergency.

### Service and support

Purchasing our products means opting for a continuous and trustful cooperation. Professional customer service, customer care, and efficient service, are provided as standard at Kern. This means that the Kern Group is available to its customers all over the world and around the clock, via its representatives.

### Personal on-site consultancy

Consultancy takes place on site, so that an optimal and customised solution can be identified and developed.

### Needs analysis

Customer needs are of the highest priority. Only thanks to the experience and knowledge gained from customers, a "tailor-made" solution can be found.

### Installation

24/7 Smart Terminals are installed by the Kern team or a locally-based partner. This ensures a trouble-free installation process.

### System integration

The system is controlled as standard with Kern software. If existing programs are available, easy integration is possible via interfaces.

### On-site employee training

Employers are trained on site. This ensures smooth handover and a uniform level of knowledge of the chosen system.

### Comprehensive support during operation

Should questions or feedback about the terminals arise, the Kern team is available at all times to provide service and support.

### Reliable service programme

The combination of 24/7 customer service and service level agreement provides an optimal service.



### Kern AG

3510 Konolfingen  
Switzerland

Phone +41 31 790 35 35  
info.smart-terminal24@kernworld.com  
www.smart-terminal24.com

### Subsidiaries

Belgium [www.kernnv.be](http://www.kernnv.be)  
France [www.kernfrance.fr](http://www.kernfrance.fr)  
Germany [www.kerngmbh.de](http://www.kerngmbh.de)  
Great Britain [www.kern.co.uk](http://www.kern.co.uk)  
Netherlands [www.kernbv.nl](http://www.kernbv.nl)  
Spain/Portugal [www.kern.es](http://www.kern.es)  
USA/Canada [www.kerninc.com](http://www.kerninc.com)